

Features

- Tube I.D. ϕ 16, 25, 32, 40, 50, 63, 80 mm.
- Opening / closing stroke move than twice the standard (MCHG2).
- Interchangeable with MCHG2 in mounting.
- Magnetic as standard.

Order example

MCHG2L-16 M

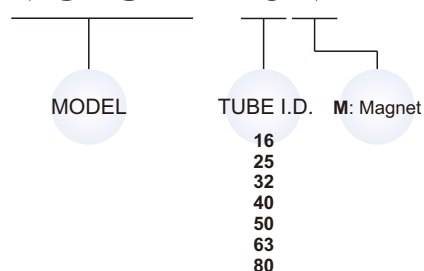

Auto switch type

RT × 1

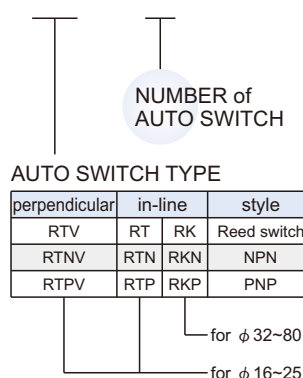

※ RT specification, please refer to page 5-14.

Specification

Model	MCHG2L-16	MCHG2L-25	MCHG2L-32	MCHG2L-40	MCHG2L-50	MCHG2L-63	MCHG2L-80	
Acting type	Double acting							
Tube I.D. (mm)	16	25	32	40	50	63	80	
Stroke (mm)	10	12	16	20	28	32	40	
Medium	Air							
Operating pressure (MPa)	0.2~0.6			0.1~0.6				
Ambient temperature	-10~+60°C (No freezing)							
Repeatability	±0.01 mm							
Max.operating frequency(c.p.m)	120			60			30	
Lubrication	Not required							
Effective gripping force N (lbf) at (0.5 MPa)	External	1.4(0.31)	4.2(0.94)	7.4(1.66)	11.8(2.65)	18.7(4.2)	33.5(7.5)	50(11.2)
	Internal	16(0.36)	4.7(1.06)	8.2(1.84)	13(2.9)	20.4(4.6)	35.9(8.1)	52.5(11.8)
Weight (g)	100	190	373	600	930	1850	2880	

※ Values for 16 to 25 are with gripping point L=20mm, for 32 to 63 with gripping point L=30mm, and for 80 gripping point L=50mm, Refer to the "Effective Holding force" data on pages through for the gripping force at each gripping position.

- Open and closed diameter values apply for external gripping of work pieces.

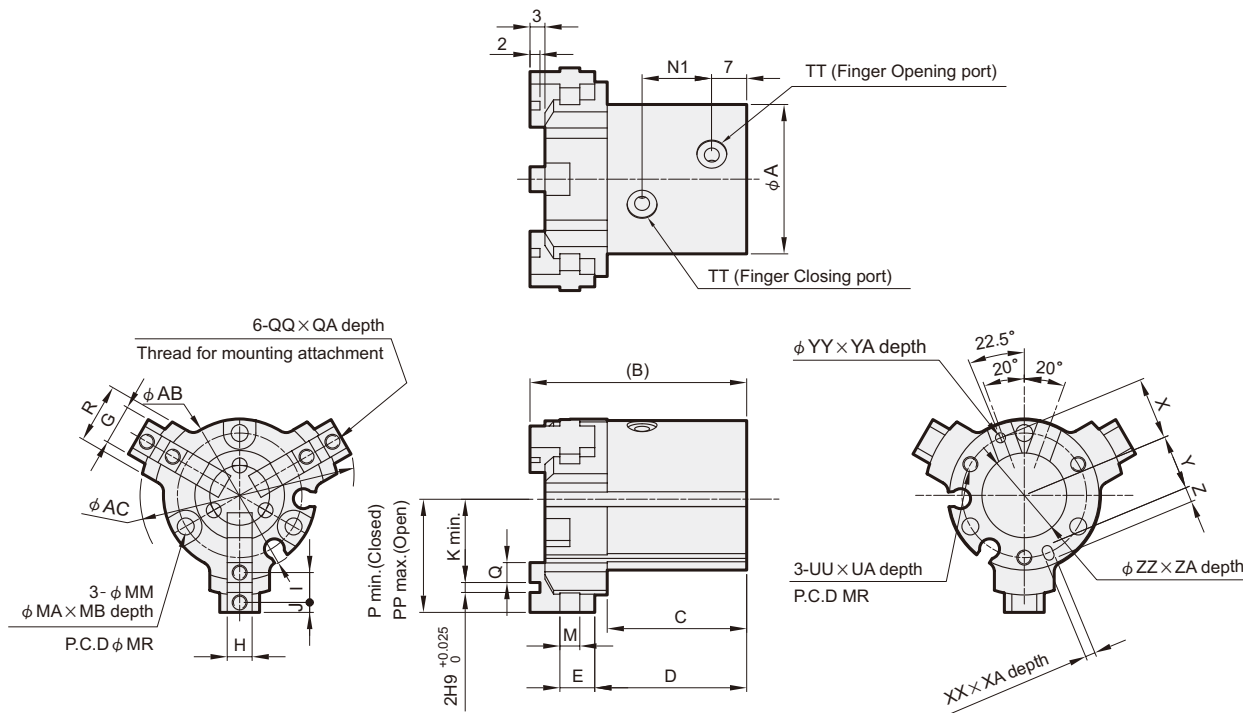

Auto switch mounting groove position (2 places)

$\phi 16$

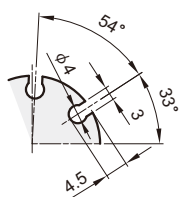

$\phi 25$

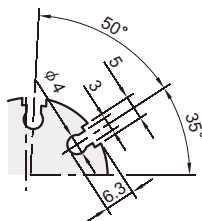

Mounting hole counter bore dimensions

$\phi 16$

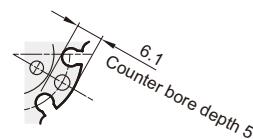

Note. The counter bore configuration differs only for the mounting hole section between the auto switch mounting grooves. ($\phi 16$ only)

Code Tube I.D.	A	AB	AC	B	C	D	E	G	H	I	J	K	M	MA	MB	MM	MR	N1	P	PP	Q	QA	QQ
16	30	30.6	40	43.5	28	30.5	7	8	5h9 ^{+0.030} ₀	6	2	12.5	4	6.5	5	3.4	25	14	18.5	23.5	4	5	M3 x 0.5
25	42	42.6	52	49	31.5	34.2	7.8	13	6h9 ^{+0.030} ₀	8	3	16	4.5	8	8	4.5	34	16.5	24	30	6	6	M3 x 0.5

Code Tube I.D.	R	TT	UA	UU	X	XA	XX	Y	YA	YY	Z	ZA	ZZ
16	12	M3 x 0.5	1.5	M3 x 0.5	12.5	2	2H9 ^{+0.025} ₀	11	2	2H9 ^{+0.025} ₀	3	1.5	17H9 ^{+0.043} ₀
25	19	M5 x 0.8	1.5	M4 x 0.7	17	3	3H9 ^{+0.025} ₀	14.5	3	3H9 ^{+0.025} ₀	5	1.5	26H9 ^{+0.052} ₀

MCHG2L Dimensions $\phi 32 \sim \phi 80$

LOWER HEIGHT OF THREE JAW GRIPPER



mindman

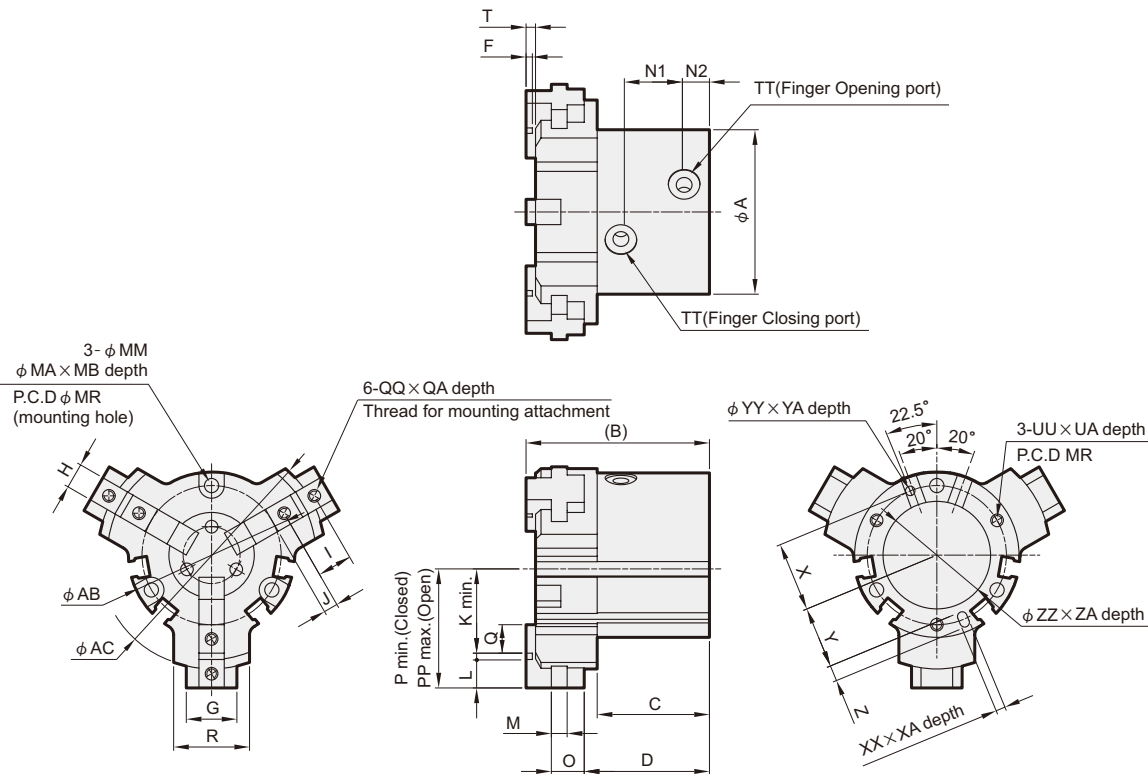

Auto switch mounting groove position (2 places)

Mounting hole counter bore dimensions

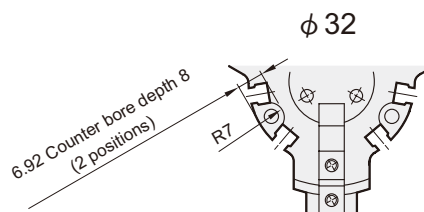
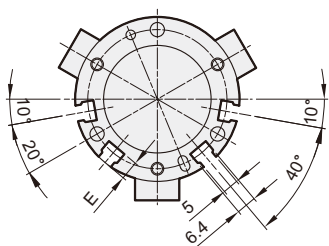

Note. The counter bore configuration differs only for the mounting hole section between the auto switch mounting grooves. ($\phi 32$ only)

Code Tube I.D.	A	AB	AC	B	C	D	E	F	G	H	I	J	K	L	M	MA	MB	MM	MR	N1	N2	O	P	PP	Q
32	52	52.6	72	58	35.5	39.6	6	2	16	8h9 ⁺⁰ _{-0.036}	11	4.5	23	2H9 ^{+0.025} ₋₀	5	8	8	4.5	44	20	8	10.4	34	42	9
40	62	62.6	82	64	38.5	42.5	8	2	18	8h9 ⁺⁰ _{-0.036}	12	4.5	25.5	3H9 ^{+0.025} ₋₀	7	9.5	9.5	5.5	53	22	9	13.5	37.5	47.5	9
50	70	70.6	104	77.5	46.5	51.3	7	2	20	10h9 ⁺⁰ _{-0.036}	14	5	32	4H9 ^{+0.030} ₋₀	8	9.5	9.5	5.5	62	29	9	17.7	46	60	10
63	86	86.6	120	89	51	58.5	7.5	3	26	12h9 ⁺⁰ _{-0.043}	17	5.5	37	6H9 ^{+0.030} ₋₀	10	11	17	6.6	76	30.5	12	19.5	54	70	11
80	106	106.6	140	116	70	78.5	9	4	30	14h9 ⁺⁰ _{-0.043}	20	6	40.5	8H9 ^{+0.036} ₋₀	11	11	23	6.6	95	37.5	14	23.5	60.5	80.5	12

Code Tube I.D.	QA	QQ	R	T	TT	UA	UU	X	XA	XX	Y	YA	YY	Z	ZA	ZZ
32	8	M4 x 0.7	24	3	M5 x 0.8	6	M4 x 0.7	22	3	3H9 ^{+0.025} ₋₀	19.5	3	3H9 ^{+0.025} ₋₀	5	2	34H9 ^{+0.062} ₋₀
40	8	M4 x 0.7	30	3	M5 x 0.8	10	M5 x 0.8	26.5	4	4H9 ^{+0.030} ₋₀	23.5	4	4H9 ^{+0.030} ₋₀	6	2	42H9 ^{+0.062} ₋₀
50	10	M5 x 0.8	32	3	M5 x 0.8	10	M5 x 0.8	31	4	4H9 ^{+0.030} ₋₀	28	4	4H9 ^{+0.030} ₋₀	6	2	52H9 ^{+0.074} ₋₀
63	10	M5 x 0.8	40	4	M5 x 0.8	12	M6 x 1	38	5	5H9 ^{+0.030} ₋₀	34.5	5	5H9 ^{+0.030} ₋₀	7	2.5	65H9 ^{+0.074} ₋₀
80	12	M6 x 1	50	5	Rc1/8	12	M6 x 1	47.5	6	6H9 ^{+0.030} ₋₀	43.5	6	6H9 ^{+0.030} ₋₀	8	3	82H9 ^{+0.087} ₋₀